

# Counter reaction balancer HKS series

Spring balancer + Reduce counter reaction

**New  
Model**

## HKS15N900-20

MIN.592~MAX.892  
Stroke 300mm

## HKS15N1300-18

MIN.792~MAX.1292  
Stroke 500mm

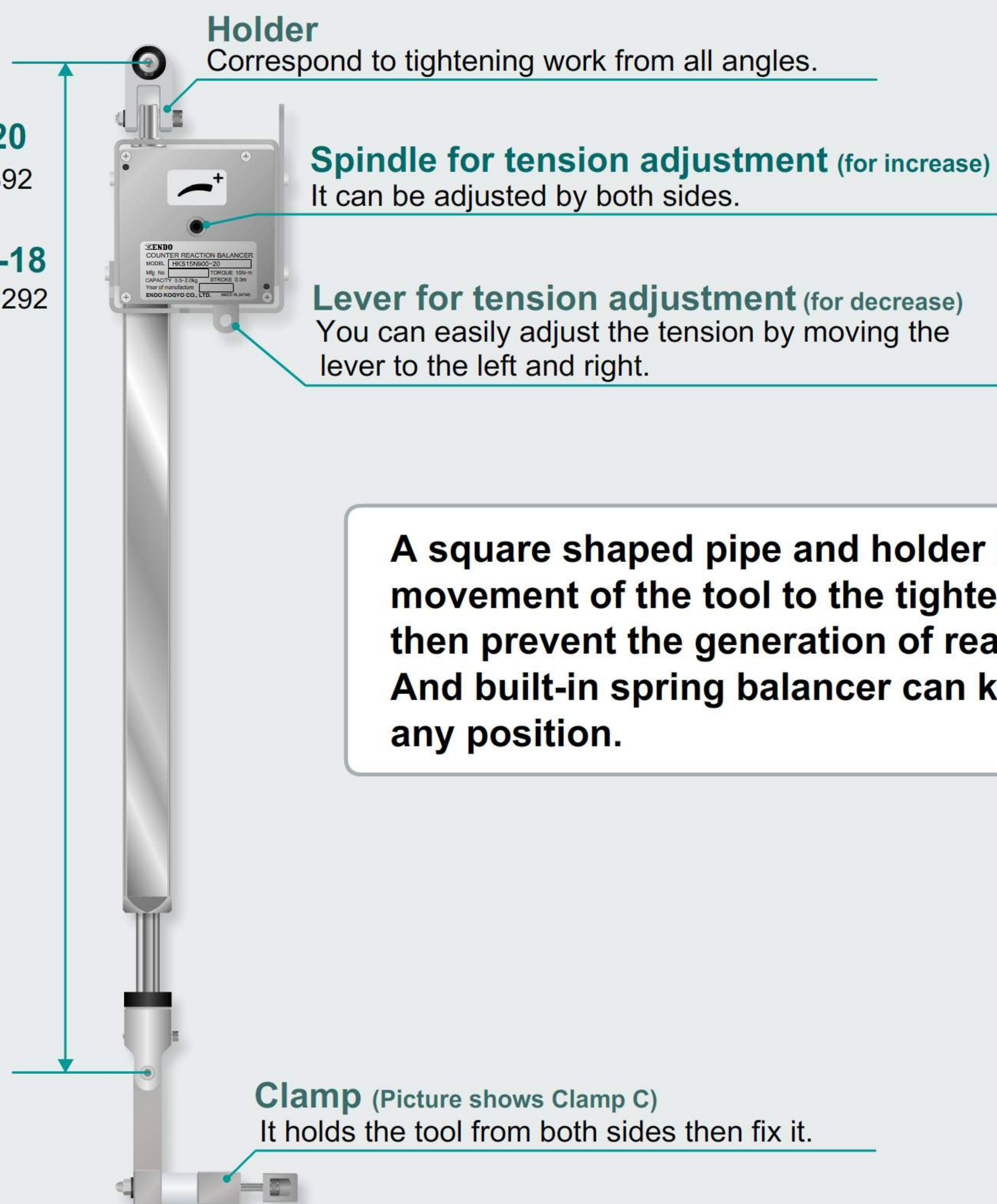

This is a good product suitable for low torque fine tightening work on the workbench.

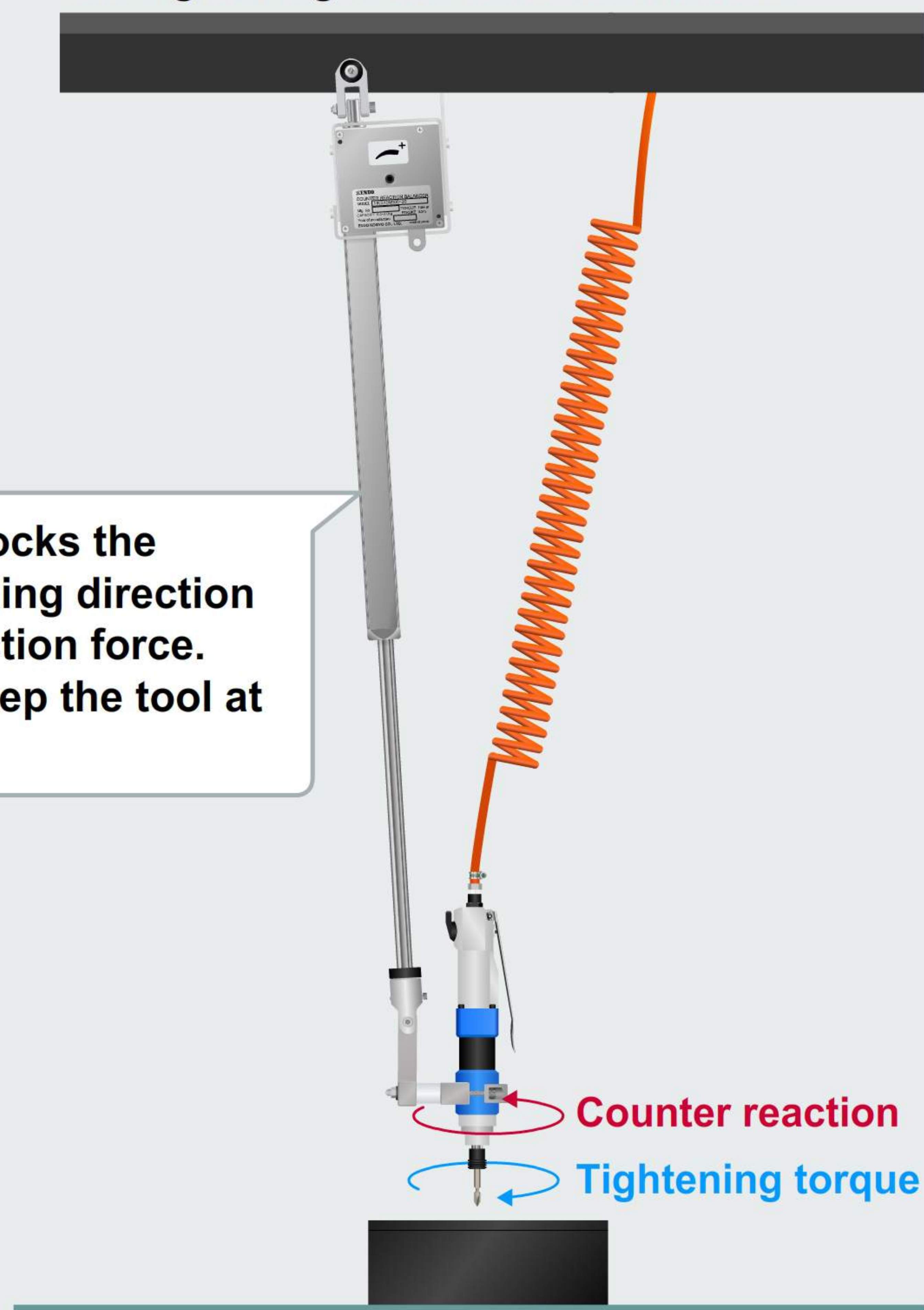

## Clamp

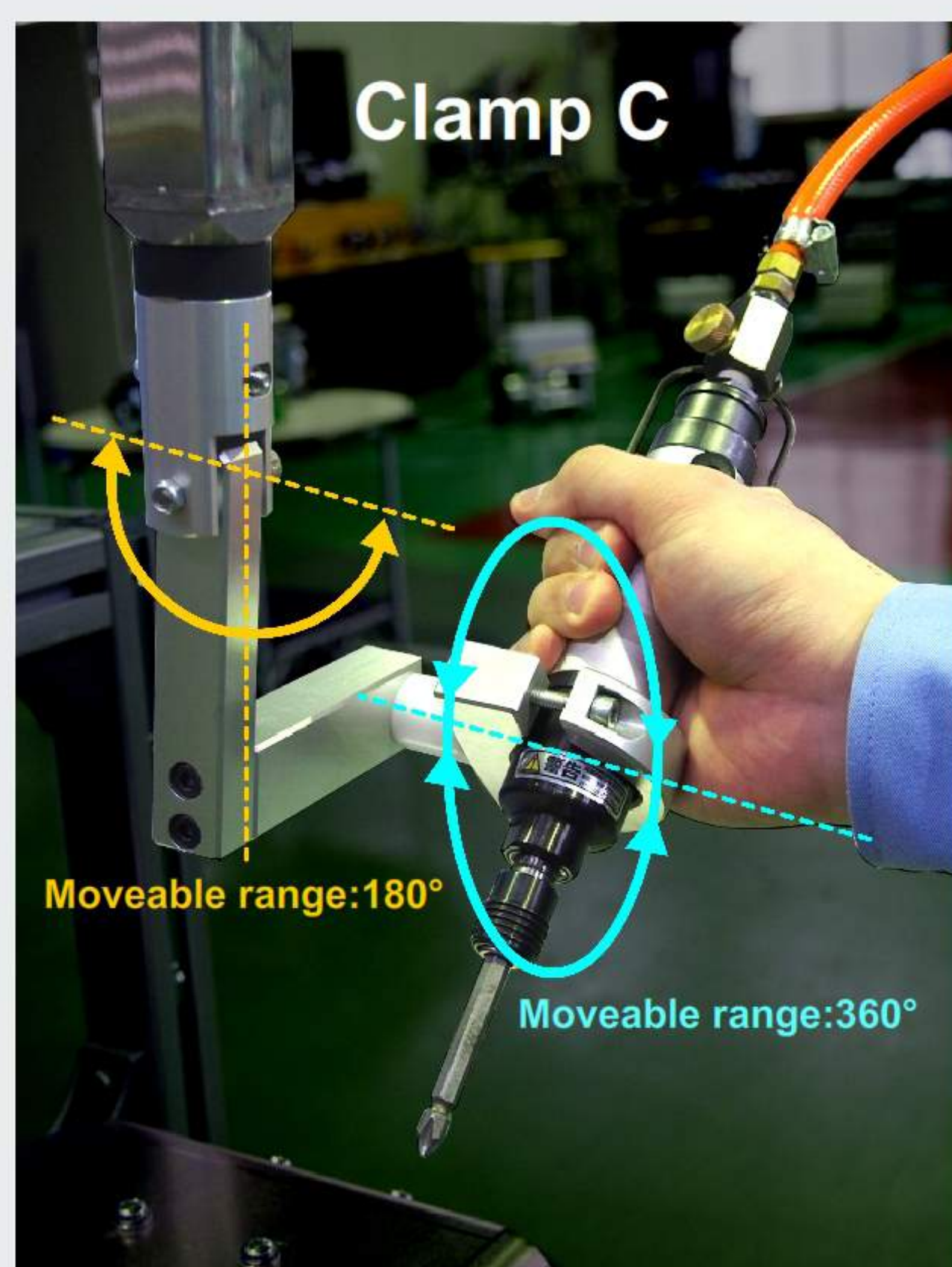

## Clamp C

The upper holder moving in the 360° direction and the clamp at hand makes the range of motion wider and make tightening work from all angles easy.

\* The working range depends on the main unit installation position from the tightening surface, the pulling angle, the length of the tool and the clamp position.

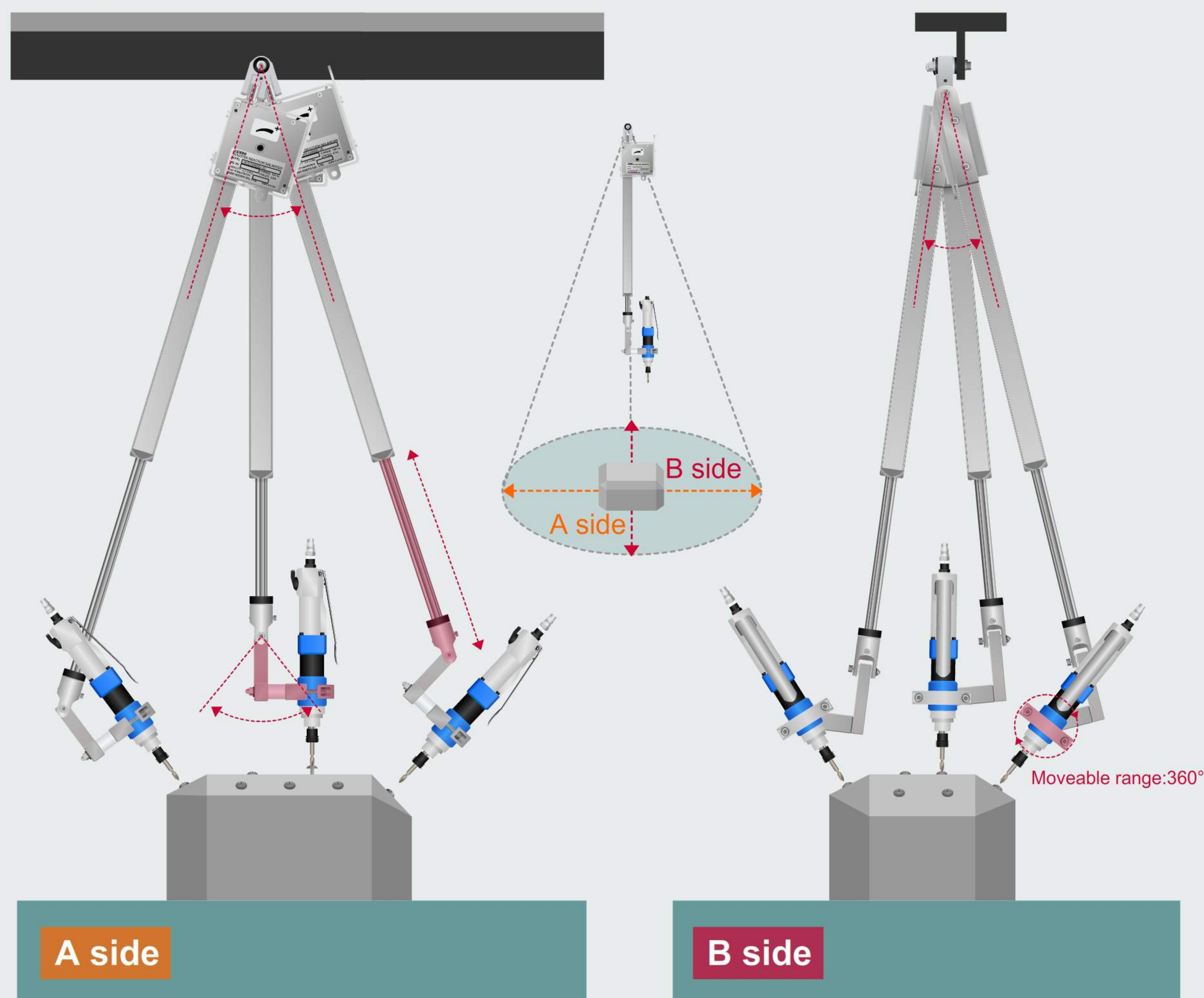

## Clamp A

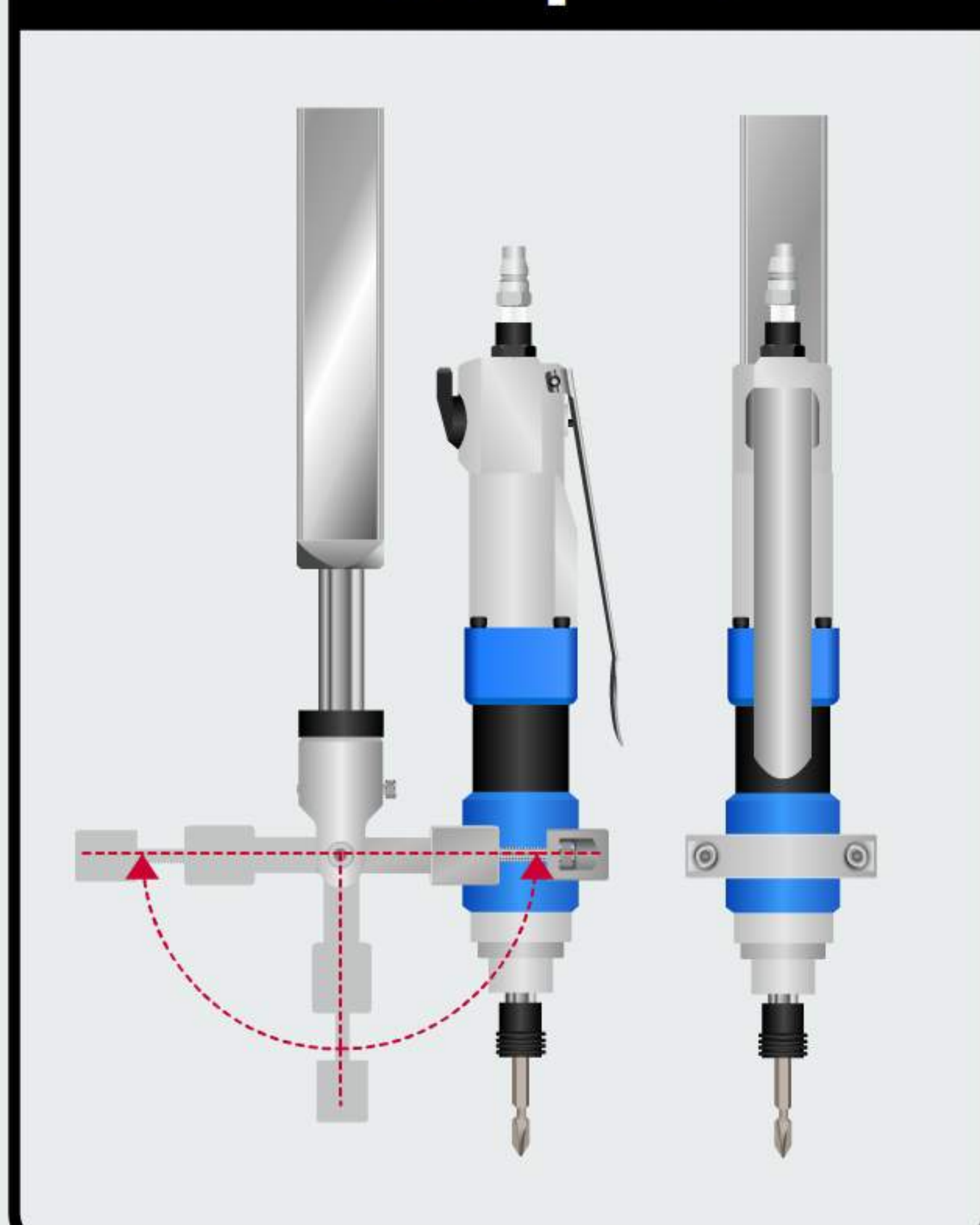



Counter reaction balancer

Model	Tightening torque (N·m)	Length (mm)	Stroke (mm)	Mass (kg)
HKS15N900-20	15	892	300	0.5~2
HKS15N1300-18	15	1292	500	0.5~1.8

Dimensions HKS15N900-20 / HKS15N1300-18

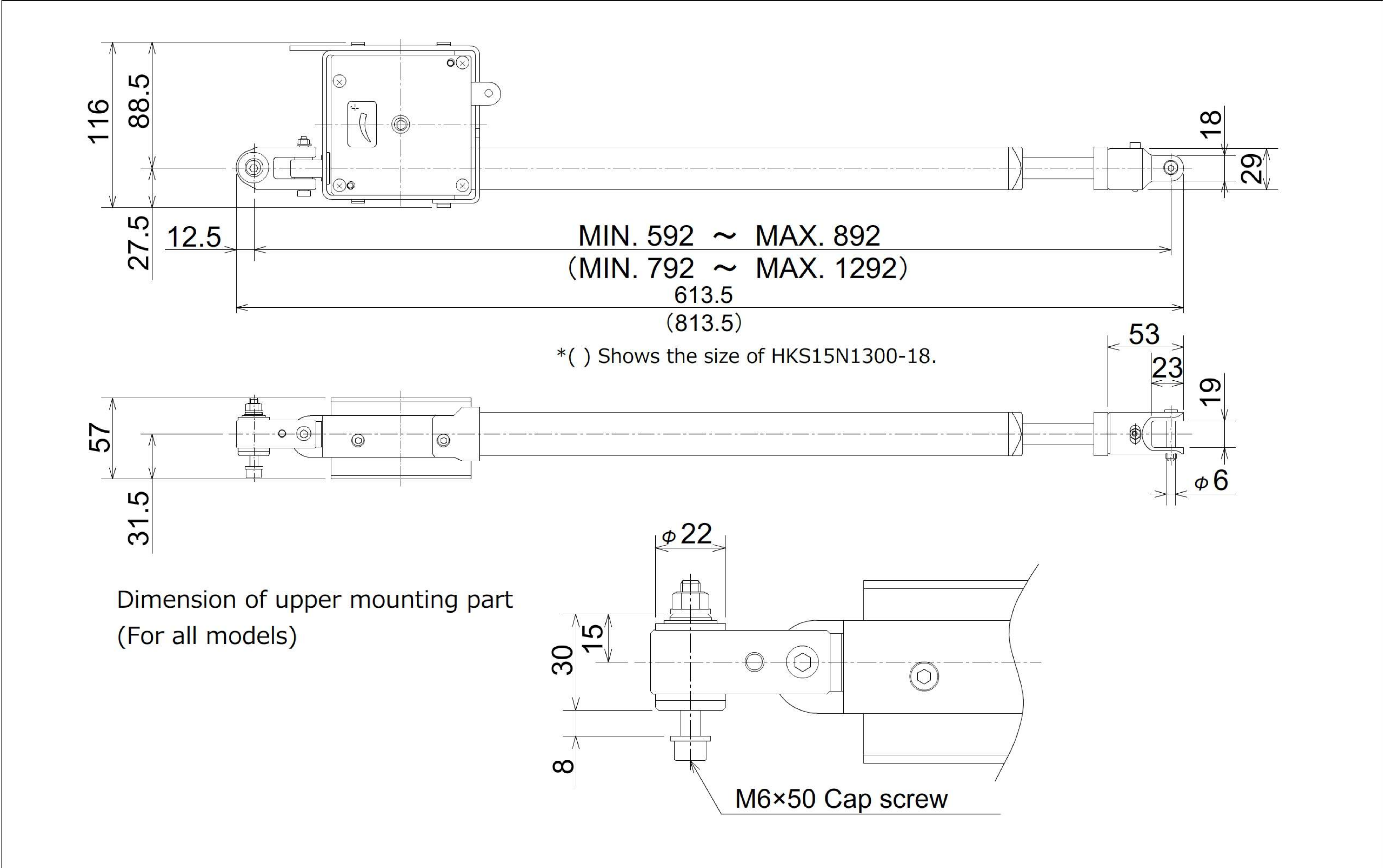

Accessories

Clamp C

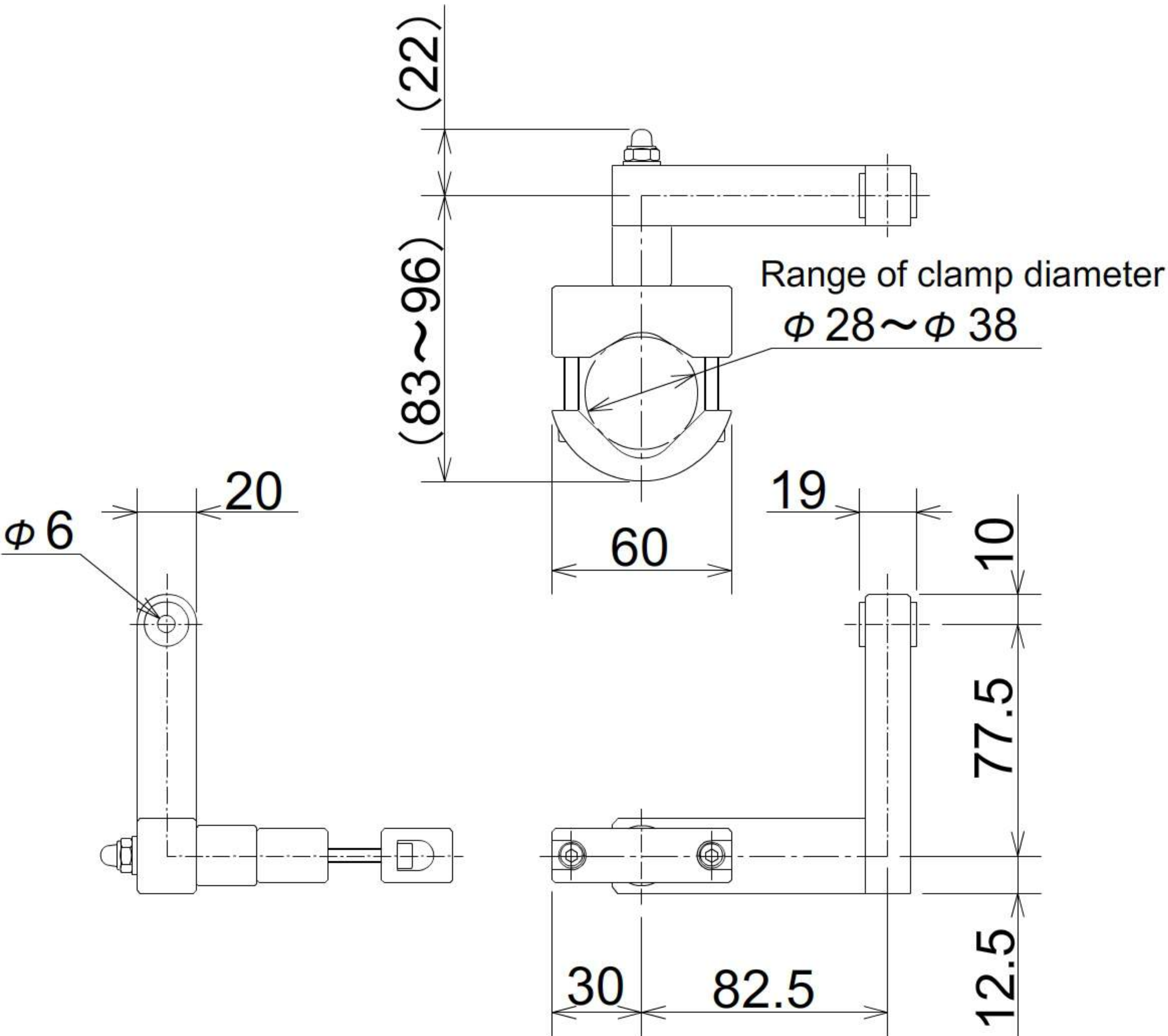

Clamp A

